

# Middle School Project Update

September 5, 2024



As of February 29, 2024



As of August 28, 2024



# Exterior Progress

- All Structural Steel in Buildings A, B & C Complete.
- All Concrete Floor Slabs in Buildings A, B & C Complete.
- Exterior Sheathing In Building C Complete & Ongoing in Building B.
- Exterior Brickwork Scheduled To Start in Building C on 09/02/24.
- Roof Installation Complete in Building C & In Progress in Building B.
- Geothermal Wells Installation Complete & Piped Over to Close to Building
- Sitework Ongoing:
  - New Site Grading & Underground Utilities Being Installed Throughout.
  - Half of Athletics Field Graded & Grass Seeded -Grass is Currently Establishing.
  - New Bus Loop Road Installation Ongoing - Currently Extends from Boys & Girls Connection Round Behind Building.
  - Building Electrical Transformer Relocated to New Location

# Interior Progress

- Interior Wall Framing Complete in Buildings A & B
- **Building C**
  - In-Wall & Above Ceiling Mechanical, Electrical & Plumbing (MEP) Close to Completion.
  - City Inspections of MEP Installations Currently Ongoing.
  - In Areas Where MEP Inspections Have Been Completed Sheetrock Installation in Progress.
  - Metal Staircase Installation In Progress.
- **Building B**
  - In-Wall & Above Ceiling Mechanical, Electrical & Plumbing (MEP) Installation in Progress.
- Installation of New Underground Utilities in Existing Cafeteria Complete.
- Strengthening of Existing Structural Columns in Building D/C Connection Area In Progress





**performing arts**  
one story, level 3

**8th grade**  
one story, level 3

**Gym**  
ground floor, level 1

**6th grade**  
two stories, levels 3 & 4

**studio arts**  
ground floor, level 2

**Fitness**  
ground floor, level 1

**7th grade**  
two stories, levels 2 & 3

New Charlottesville Middle School

# CHARLOTTESVILLE MIDDLE SCHOOL - PHASING PLAN

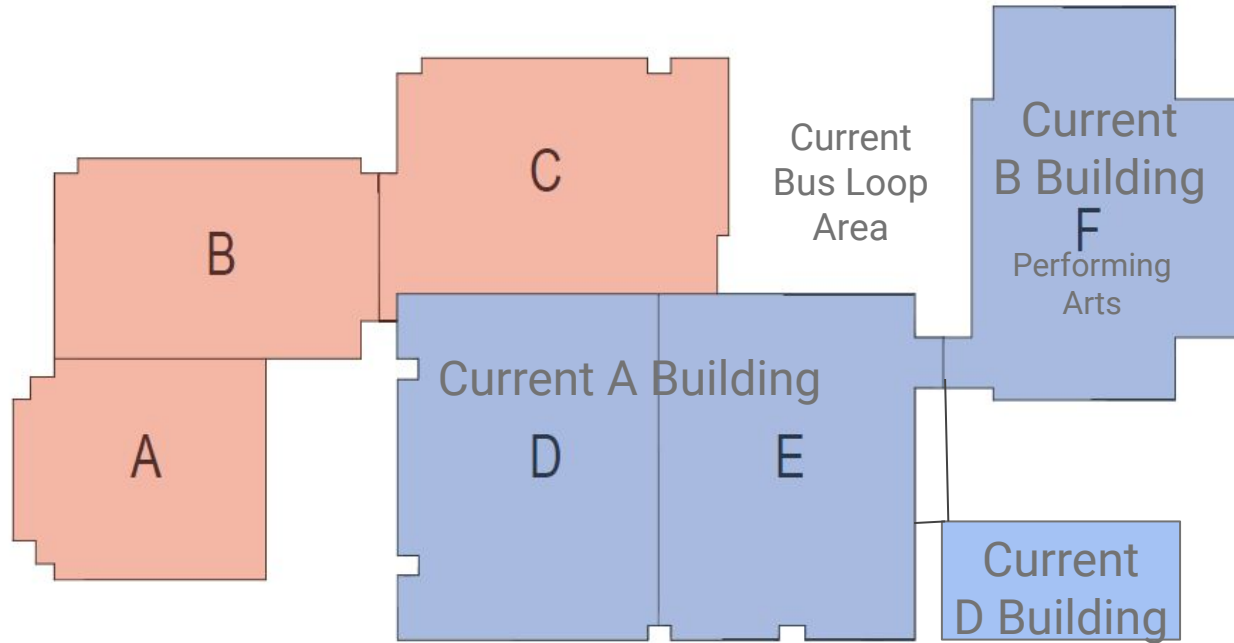

 PHASE 1 - SUBSTANTIAL COMPLETION (BUILDINGS ABC): 06/15/2025

 PHASE 2 (PROJECT) - SUBSTANTIAL COMPLETION (BUILDINGS DEF): 07/01/2026



# Exterior View - August 22, 2024

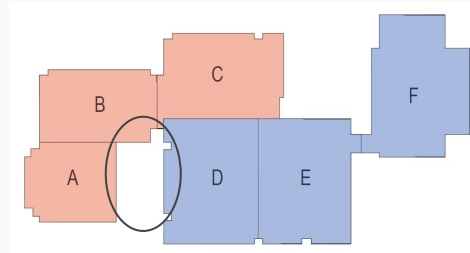

# Exterior View - August 22, 2024

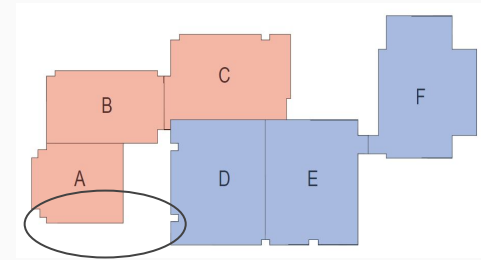

# Exterior View - August 22, 2024

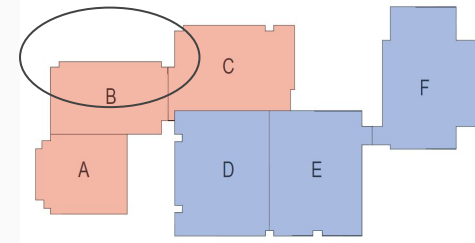

# Exterior View - August 22, 2024

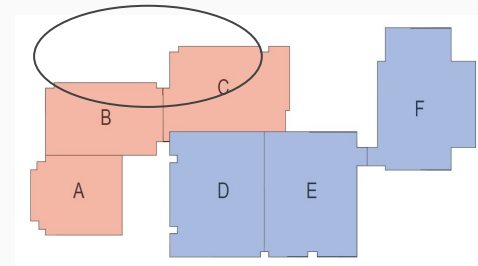

# Exterior View - August 22, 2024

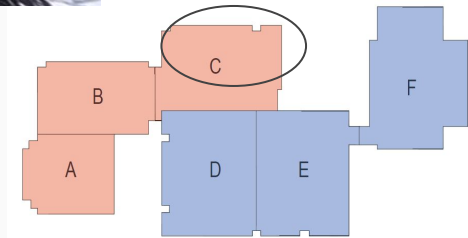

4th Floor Interior View (August 22, 2024)



# Interior Views (August 22, 2024)



# Interior Views (August 22, 2024)





# Big-Picture of Construction Plan

## Phase 1

**June 12 - Summer 2025**

- Students will learn in the old buildings while the new construction is built on athletic fields and building C
- No access to athletic fields or gym during this time, but a plan is in place.

## Phase 2

**Summer 2025 - Summer 2026**

- Students will learn in the new building while the old spaces are renovated

Interim Space Planning  
Now In Progress

6th grade  
two levels

7th grade  
two levels

# Logistics

## Buford MS this school year (2024-2025):

- No significant changes from the current operating conditions

---

## Buford MS plan for next school year (2025-2026)

- New traffic patterns (TBD)

### First Semester

- 7th & 8th grade move into the new buildings
  - Some spaces in the new buildings will be used differently for this interim year for the performing arts and engineering
- Current A & B buildings not available (the main & auditorium buildings)
- D building classrooms still in use for the first semester:
  - Nutrition Services: cold food prep & serving
    - Hot food prepped off site and delivered (like J-Via)
  - Dining
  - Breakout/Meeting spaces (outside of lunch times)

### After Winter Break

- D building closes
- NEW kitchen and dining commons open

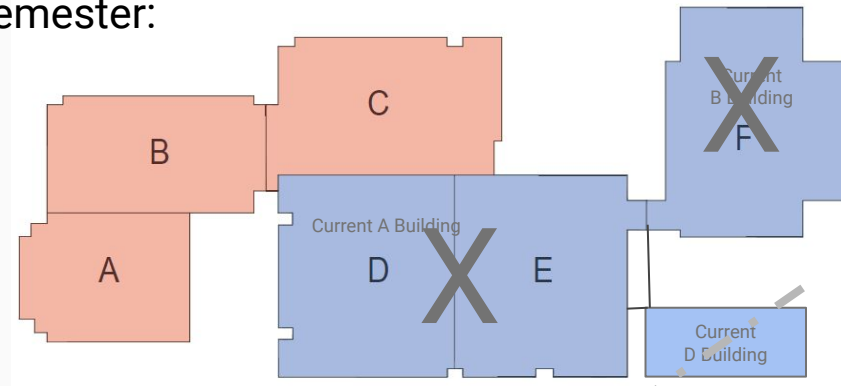

# Which students will be affected?

LEGEND: ■ Elementary Schools ■ Walker Campus ■ CHS ■ Buford MS / CMS

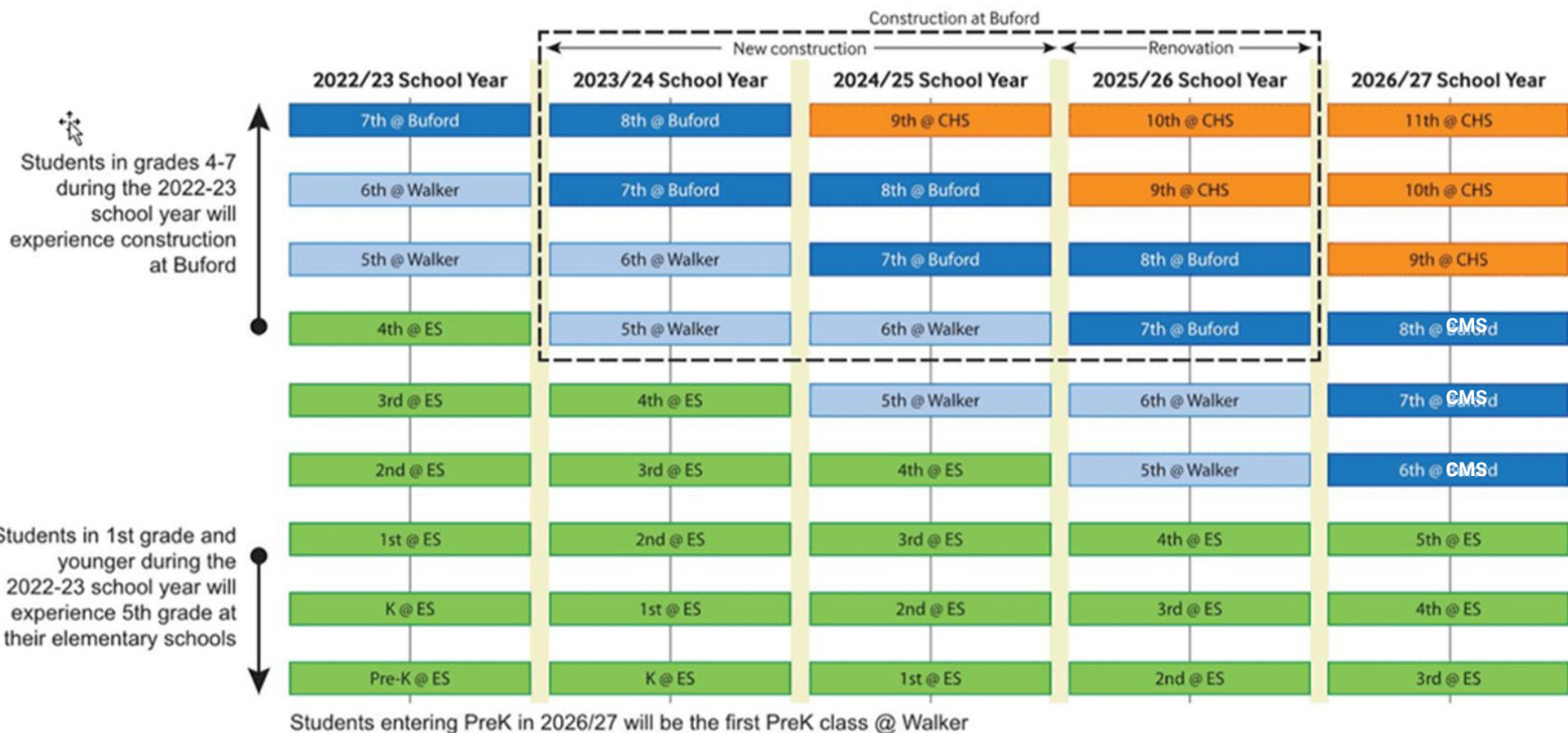

When will this effect me and my students?

# Charlottesville Middle School Opening August 2026

For more information:

<https://charlottesvilleschools.org/facilities>

Middle School Modernization